

NORDIC NATURALS DISPLAY ASSEMBLY

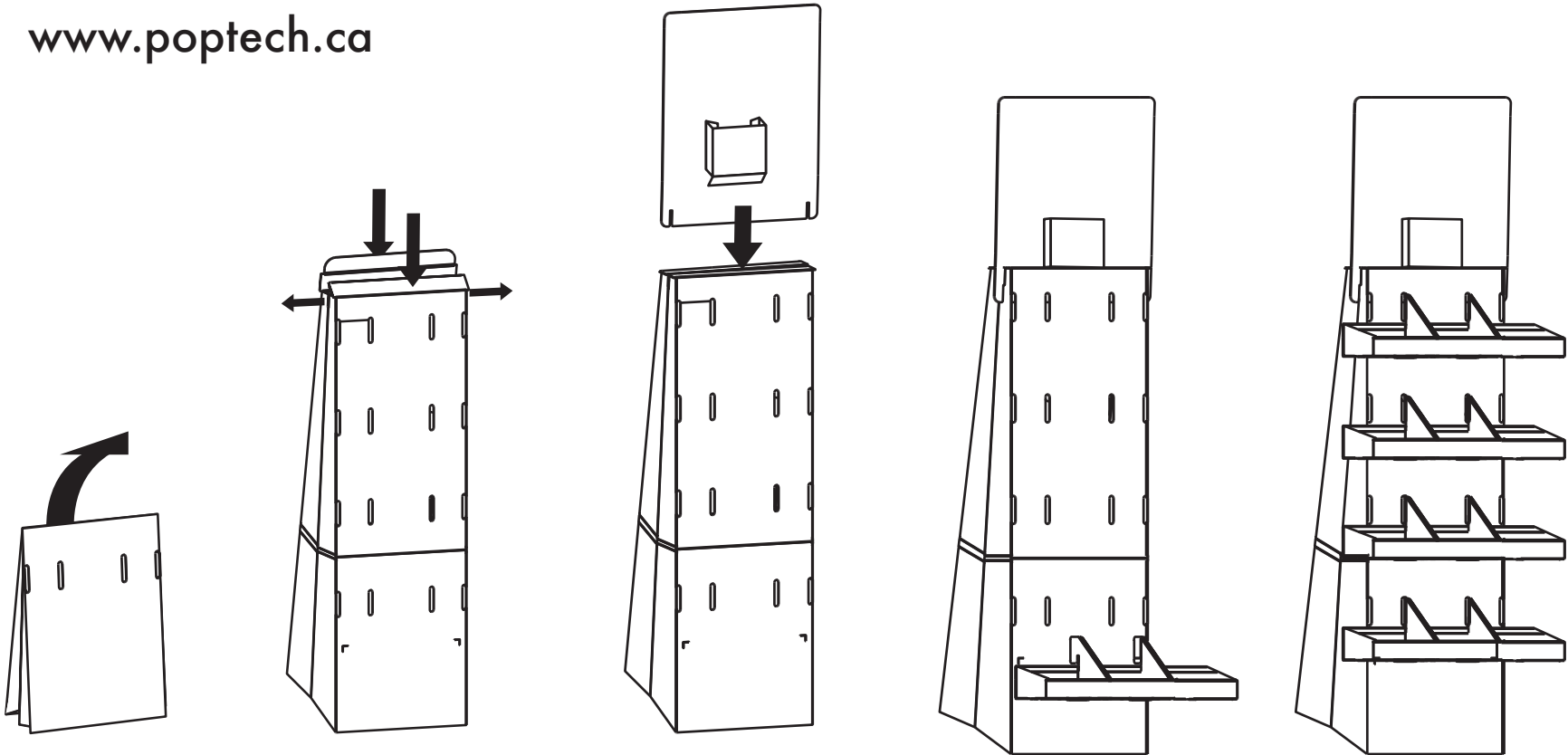

1. Unfold base.

2. Pull sides of base outwards. Base pops into place. Fold in flaps at top of base.

3. Lock bottom tab of pocket into header, and slide header card down into slots at top of base.

4. Hook trays onto base.

5. Assembly complete.

IMPORTANT : PLEASE NOTE

In the event that these instructions are not properly followed, Poptech will not be held responsible for any problems associated with the display.