

1. Fold up back of tray and fold flanges inwards.

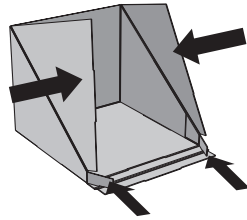

2. Fold side flaps over flanges. Fold small tabs on front of tray inwards.

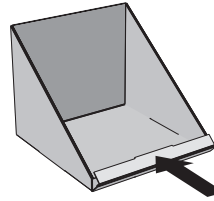

3. Fold front flap over tabs and lock into place.

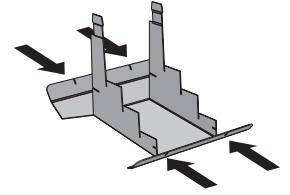

4. Fold up step supports. Lock front and back flaps into slots.

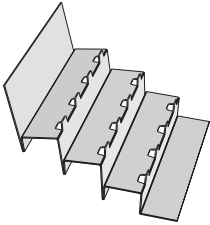

5. Fold up steps as shown in image above.

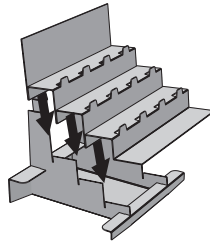

6. Slide slots on bottom of steps into slots on top of step supports.

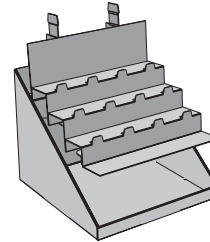

7. Place assembled steps into tray.

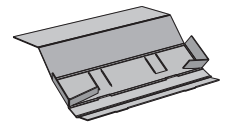

8. Fold up sides of top step, then wrap front lip around flanges. Fold down long flap at back of tray.

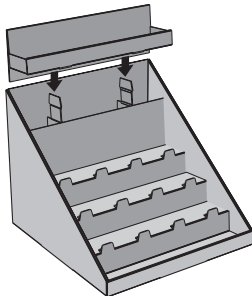

9. Slide top step down onto tabs on top of steps.

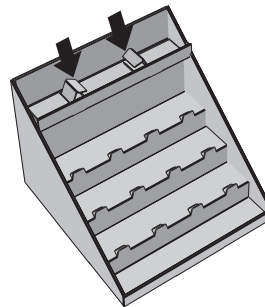

10. Fold tabs down and push ends down through slots close to middle of tray.

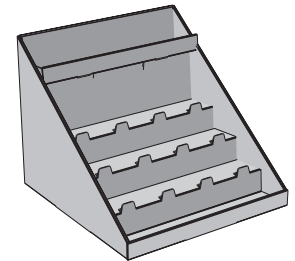

11. Tray assembly complete.

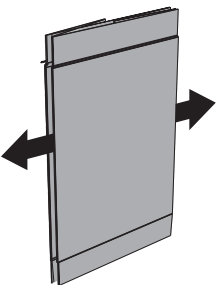

12. Unfold base.

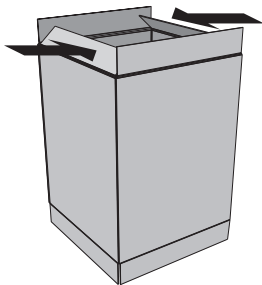

13. Fold top and bottom flaps down into base.

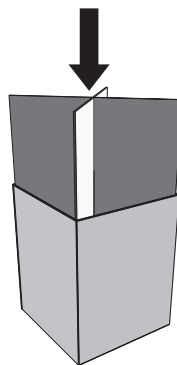

14. Interlock two thick slotted pieces and slide them down into base.

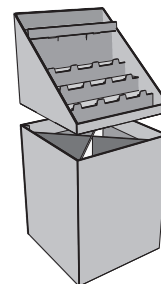

15. Place tray inside base.

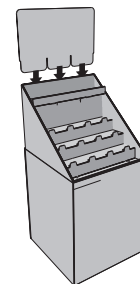

16. Attach header card to back of tray.

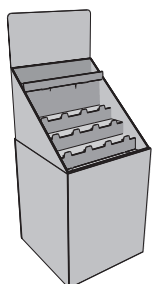

17. Assembly complete.

## Important: Please note

In the event that these instructions are not properly followed, Poptech will not be held responsible for any problems associated with the display.