

A FRAME DISPLAY ASSEMBLY

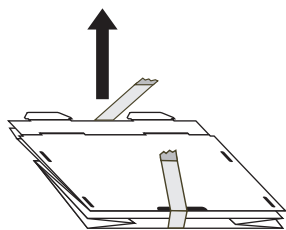

1. Remove wrap and lift up.

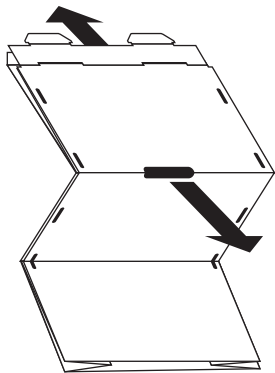

2. Display pops into place. If display does not pop open immediately, insert fingers into holes on front and back of display and pull outwards.

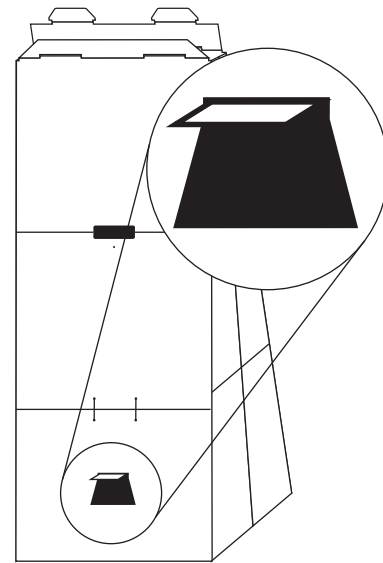
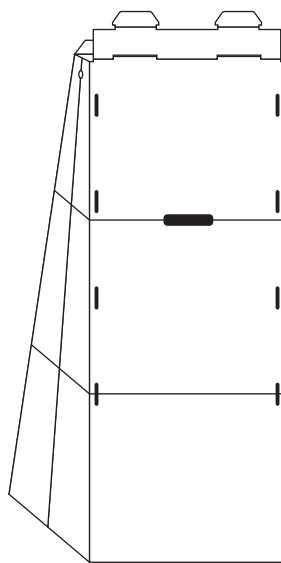

3. On back of display, ensure tab sticks out, and is flush with top of hole.

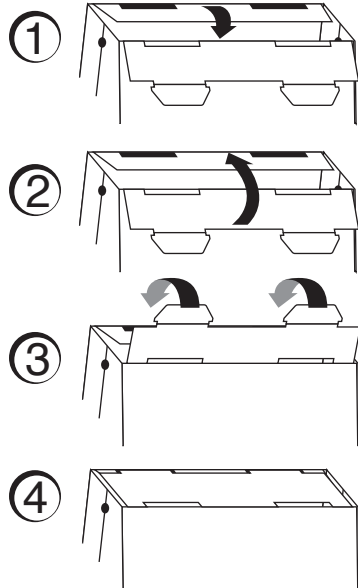

4. At top of display, fold flap with holes underneath flap with tabs, and lock them together.

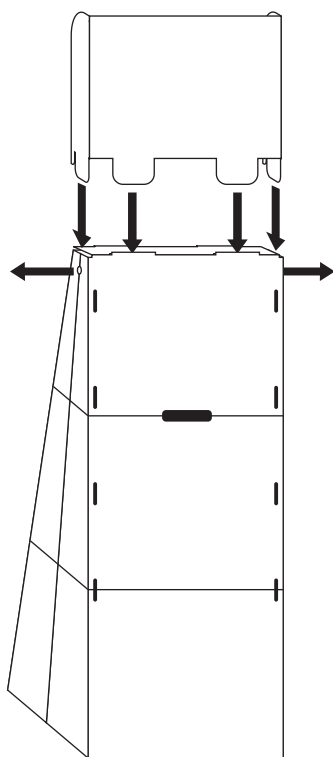

5. Fold side flaps back, and insert all 4 tabs on header card into the appropriate slots. Insert fingers into holes on side of display and pull outwards for easier insertion.

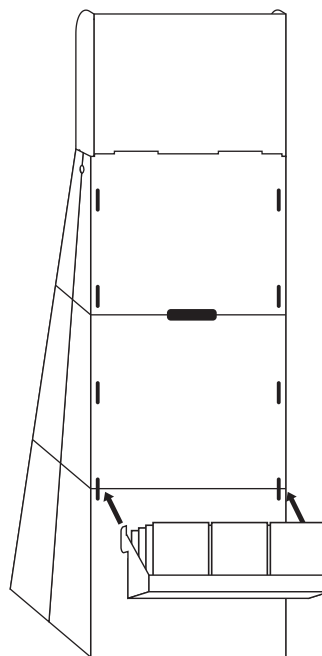

6. Lock shelf tabs into holes. It is important that this display is loaded from the bottom to the top!

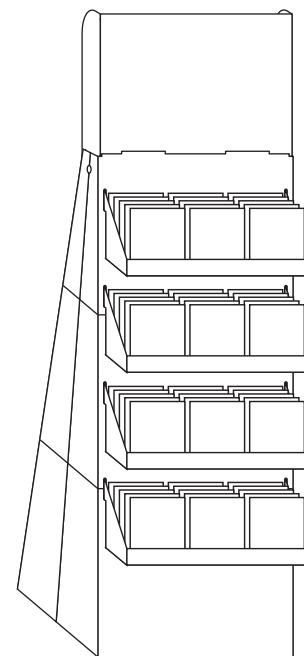

7. Assembly complete!

IMPORTANT: PLEASE NOTE

Load display from bottom to top.

Do NOT drag or move display across the floor when loaded with product.

In the event that these instructions are not properly followed, Poptech will not be held responsible for any problems associated with the display.